

IMPORTANT NOTE: When installing Rational windows and accessories, please ensure compliance with national building regulations and British/European standards where necessary. This drawing is for guidance only and the customer must be satisfied that the principles outlined in this drawing are effectively transposed to suit specific project requirements and site conditions.

All dimensions are in millimetres where shown. Do not scale.

NOTES:

1. External weather seal to be either Tremco-Ilbruck joint sealing tape sized to suit finished joint size or ARBOSIL 1090 silicone seal and polyethelene backing rod.
2. Fixings and brackets to be installed strictly in accordance with Rational installation guidance.
3. Fixing grounds must be able to withstand all loads transmitted from and through the Rational system.

~~~~~ primary weather line

—○— primary air barrier line



|     |      |    |             |
|-----|------|----|-------------|
| Rev | Date | By | Description |
|     |      |    |             |
|     |      |    |             |
|     |      |    |             |
|     |      |    |             |

Title:

Rational AURAPLUS  
TYPICAL CILL DETAIL  
brick/block masonry

Scale: 1:2 approx @ A4

Drawing no:

Date: January 2017

AURA+.W1.01.A.C.001

Drawn: Studio62

Status: approved

Revision:

**rational**<sup>®</sup>

Rational Windows (UK) Ltd.  
7 Avonbury Business Park, Howes Lane,  
Bicester, Oxfordshire. OX26 2UA

tel: 01869 248181

fax: 01869 249693

web: www.rational.co.uk

© Rational Windows (UK) Ltd. This drawing must not be copied, reproduced or published in whole or in part for commercial gain without prior written permission of Rational Windows (UK) Ltd.









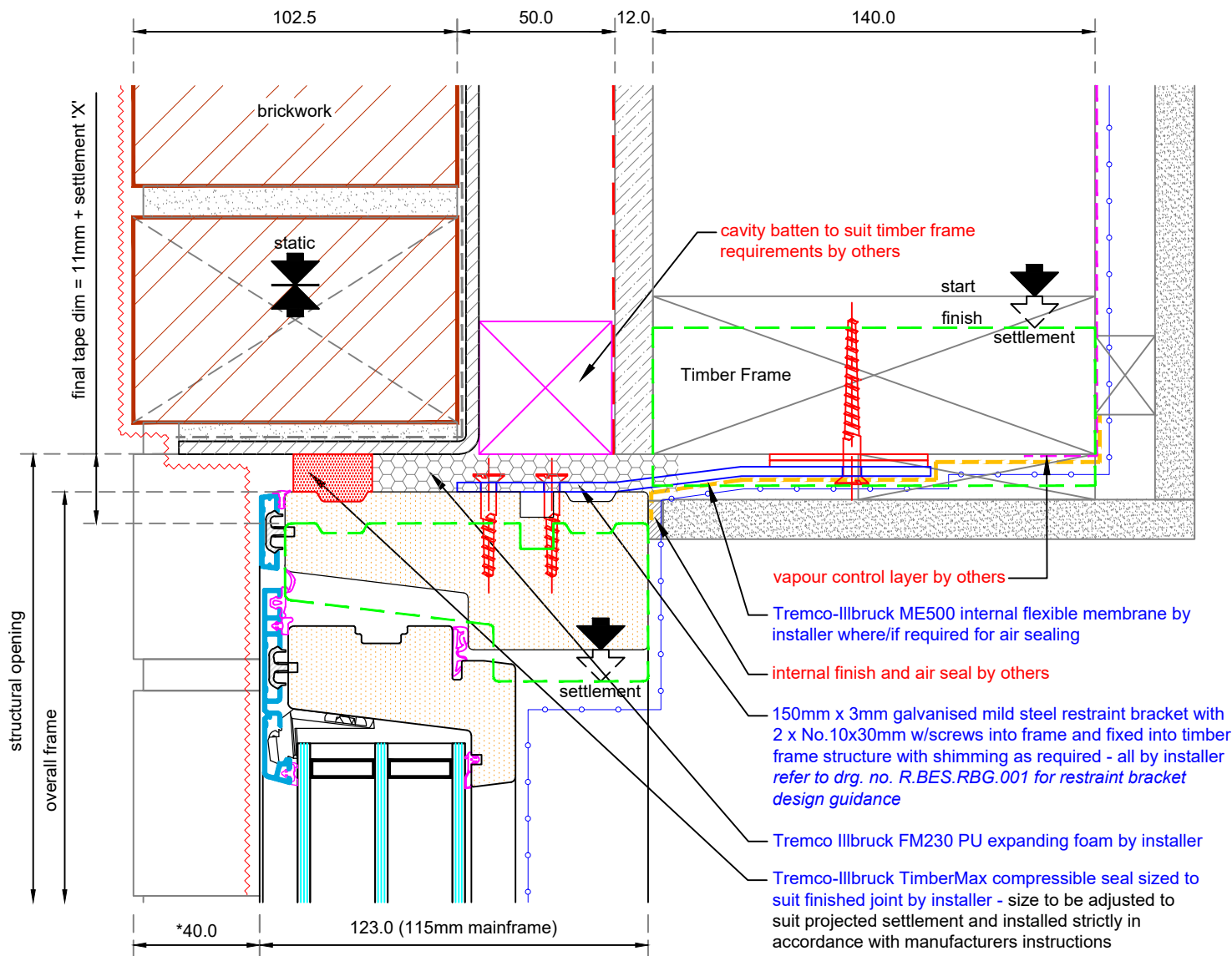

| settlement 'X' per storey (up to 5 stories) |                                      |                                      |
|---------------------------------------------|--------------------------------------|--------------------------------------|
| location                                    | using solid timber joist floors (mm) | using engineered i-joist floors (mm) |
| ground storey                               | 3                                    | 3                                    |
| first storey                                | 12                                   | 9                                    |
| second storey                               | 21                                   | 15                                   |
| third storey                                | 30                                   | 21                                   |
| fourth storey                               | 39                                   | 27                                   |
| fifth storey                                | 48                                   | 33                                   |

Source: LABC warranty technical manual v.7

#### NOTES:

- \*window setback dimension to be adjusted to ensure that required Tremco Ilbruck tape width does not encroach over timber frame structure - refer to manufacturers literature for tape size in relation to storey settlement
- timber frame insulation omitted for clarity
- window fixings must be to timber frame only, NOT to external structure/finish which remains static during settlement
- data in adjacent table is to be used in absence of project specific calculations and assumes use of timber with moisture content of less than 20% bearing on concrete ground floor

**IMPORTANT NOTE:** When installing Rational windows and accessories, please ensure compliance with national building regulations and British/European standards where necessary. This drawing is for guidance only and the customer must be satisfied that the principles outlined in this drawing are effectively transposed to suit specific project requirements and site conditions.

All dimensions are in millimetres where shown. Do not scale.

#### NOTES:

1. External weather seal to be either Tremco-Ilbruck joint sealing tape sized to suit finished joint size or ARBOSIL 1090 silicone seal and polyethylene backing rod.
2. Fixings and brackets to be installed strictly in accordance with Rational installation guidance.
3. Fixing grounds must be able to withstand all loads transmitted from and through the Rational system.

primary weather line  
primary air barrier line



| Rev | Date | By | Description |
|-----|------|----|-------------|
|     |      |    |             |
|     |      |    |             |
|     |      |    |             |
|     |      |    |             |

Title:

Rational AURAPLUS  
**TYPICAL HEAD DETAIL**  
brick/timber frame

Scale: 1:2 approx @ A4

Drawing no:

Date: January 2017

AURA+.W1.01.B.H.001

Drawn: Studio62

Status: approved

Revision:

**rational**<sup>®</sup>

Rational Windows (UK) Ltd.  
7 Avonbury Business Park, Howes Lane,  
Bicester, Oxfordshire. OX26 2UA

tel: 01869 248181  
fax: 01869 249693  
web: www.rational.co.uk

© Rational Windows (UK) Ltd. This drawing must not be copied, reproduced or published in whole or in part for commercial gain without prior written permission of Rational Windows (UK) Ltd.





**IMPORTANT NOTE:** When installing Rationel windows and accessories, please ensure compliance with national building regulations and British/European standards where necessary. This drawing is for guidance only and the customer must be satisfied that the principles outlined in this drawing are effectively transposed to suit specific project requirements and site conditions.

**NOTES:**

1. External weather seal to be either Tremco-Ilbruck joint sealing tape sized to suit finished joint size or ARBOSIL 1090 silicone seal and polyethelene backing rod.
2. Fixings and brackets to be installed strictly in accordance with Rational installation guidance.
3. Fixing grounds must be able to withstand all loads transmitted from and through the Rational system.

—○— primary air barrier line

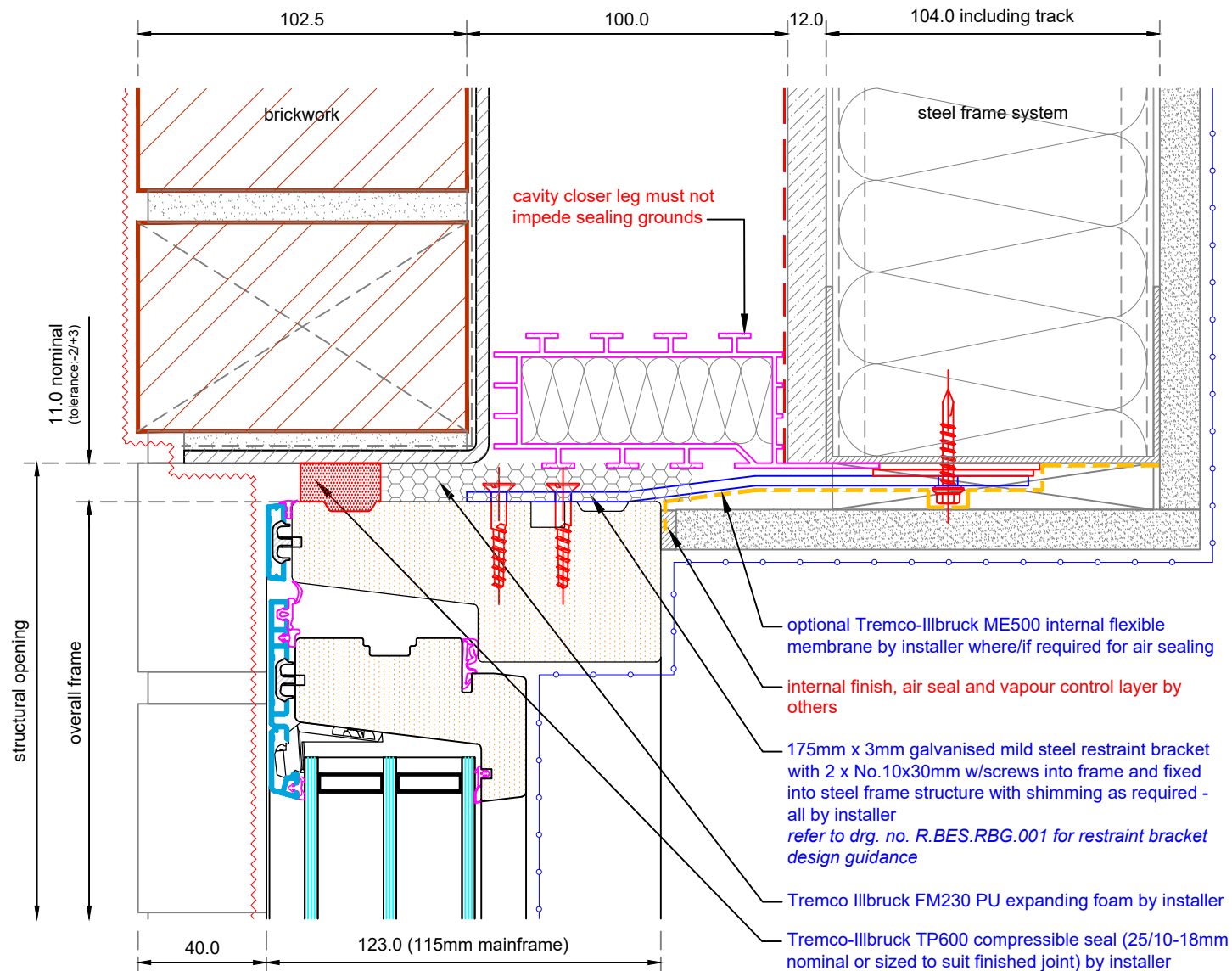

|     |      |    |             |
|-----|------|----|-------------|
|     |      |    |             |
|     |      |    |             |
|     |      |    |             |
|     |      |    |             |
| Rev | Date | By | Description |

Title:

Rational AURAPLUS  
**TYPICAL HEAD DETAIL**  
brick/steel frame system

|                        |                                        |
|------------------------|----------------------------------------|
| Scale: 1:2 approx @ A4 | Drawing no:<br><br>AURA+.W1.01.C.H.001 |
| Date: January 2017     |                                        |
| Drawn: Studio62        |                                        |
| Status: approved       | Revision:                              |

# rational

**Rational Windows (UK) Ltd.**  
7 Avonbury Business Park, Howes Lane,  
Bicester, Oxfordshire. OX26 2UA

tel: 01869 248181  
fax: 01869 249693  
web: [www.rationel.co.uk](http://www.rationel.co.uk)

© Rational Windows (UK) Ltd. This drawing must not be copied, reproduced or published in whole or in part for commercial gain without prior written permission of Rational Windows (UK) Ltd.













\*where smaller setback is required,  
please reconsider structural support  
for the window load

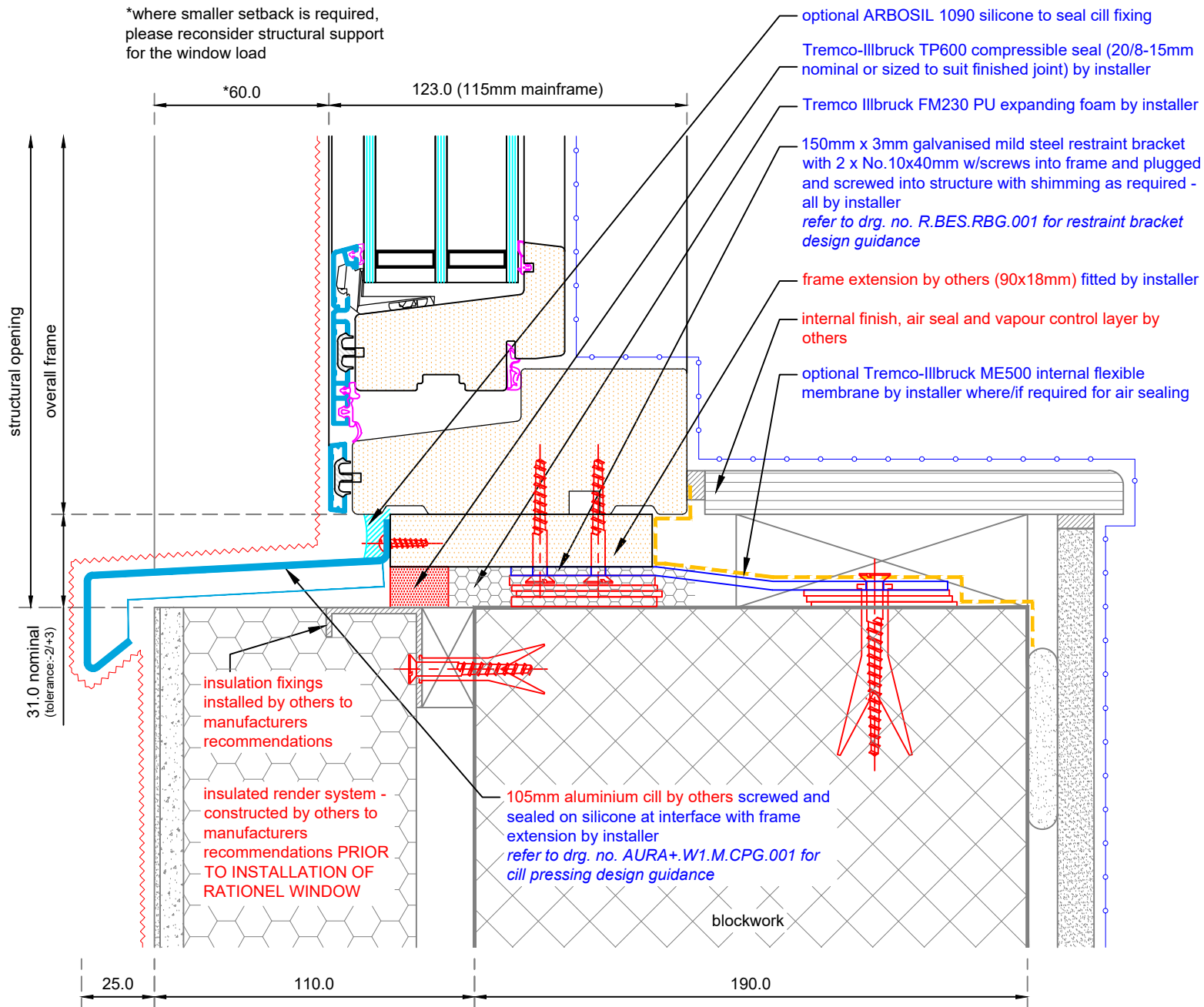

**IMPORTANT NOTE:** When installing Rationel windows and accessories, please ensure compliance with national building regulations and British/European standards where necessary. This drawing is for guidance only and the customer must be satisfied that the principles outlined in this drawing are effectively transposed to suit specific project requirements and site conditions.

All dimensions are in millimetres where shown. Do not scale.

#### NOTES:

1. External weather seal to be either Tremco-Ilbruck joint sealing tape sized to suit finished joint size or ARBOSIL 1090 silicone seal and polyethelene backing rod.
2. Fixings and brackets to be installed strictly in accordance with Rationel installation guidance.
3. Fixing grounds must be able to withstand all loads transmitted from and through the Rationel system.

primary weather line

primary air barrier line



| Rev | Date | By | Description |
|-----|------|----|-------------|
|-----|------|----|-------------|

Title:

Rationel AURAPLUS  
**TYPICAL CILL DETAIL**  
insulated render/block masonry

Scale: 1:2 approx @ A4

Drawing no:

Date: January 2017

AURA+.W1.02.A.C.001

Drawn: Studio62

Status: approved

Revision:

**rationel**<sup>®</sup>

Rationel Windows (UK) Ltd.  
7 Avonbury Business Park, Howes Lane,  
Bicester, Oxfordshire. OX26 2UA

tel: 01869 248181

fax: 01869 249693

web: www.rationel.co.uk

© Rationel Windows (UK) Ltd. This drawing must not be copied, reproduced or published in whole or in part for commercial gain without prior written permission of Rationel Windows (UK) Ltd.

**IMPORTANT NOTE:** When installing Rationel windows and accessories, please ensure compliance with national building regulations and British/European standards where necessary. This drawing is for guidance only and the customer must be satisfied that the principles outlined in this drawing are effectively transposed to suit specific project requirements and site conditions.

All dimensions are in millimetres where shown. Do not scale.

#### NOTES:

1. External weather seal to be either Tremco-Ilbruck joint sealing tape sized to suit finished joint size or ARBOSIL 1090 silicone seal and polyethelene backing rod.
2. Fixings and brackets to be installed strictly in accordance with Rationel installation guidance.
3. Fixing grounds must be able to withstand all loads transmitted from and through the Rationel system.

~~~~~ primary weather line  
 ---o--- primary air barrier line

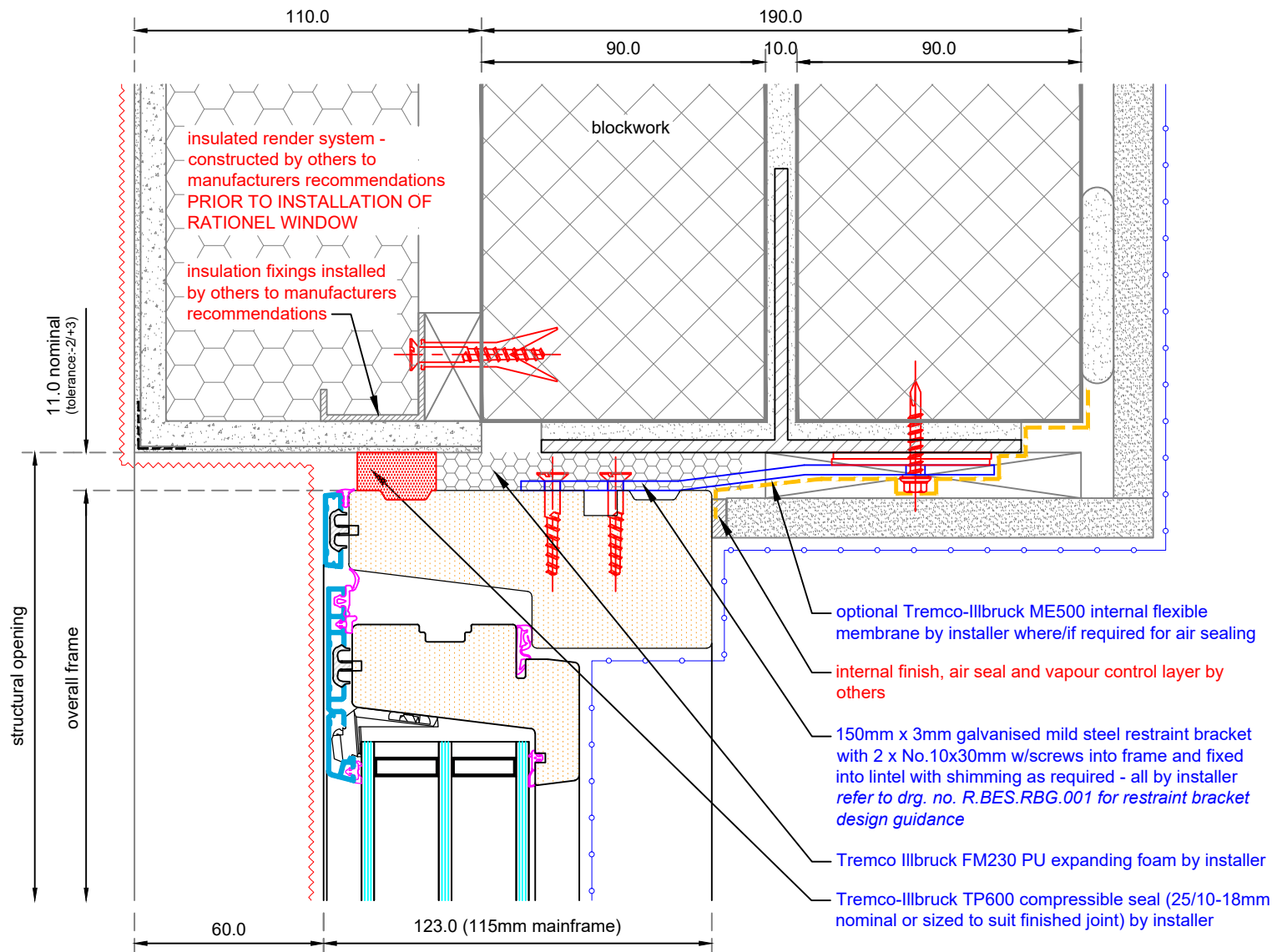

| | | | |
|-----|------|----|-------------|
| Rev | Date | By | Description |
| | | | |
| | | | |
| | | | |
| | | | |

Title:

Rationel AURAPLUS
TYPICAL HEAD DETAIL
 insulated render/block masonry

Scale: 1:2 approx @ A4

Drawing no:

Date: January 2017

AURA+.W1.02.A.H.001

Drawn: Studio62

Status: approved

Revision:

rationel[®]

Rationel Windows (UK) Ltd.
 7 Avonbury Business Park, Howes Lane,
 Bicester, Oxfordshire. OX26 2UA

tel: 01869 248181

fax: 01869 249693

web: www.rationel.co.uk

© Rationel Windows (UK) Ltd. This drawing must not be copied, reproduced or published in whole or in part for commercial gain without prior written permission of Rationel Windows (UK) Ltd.

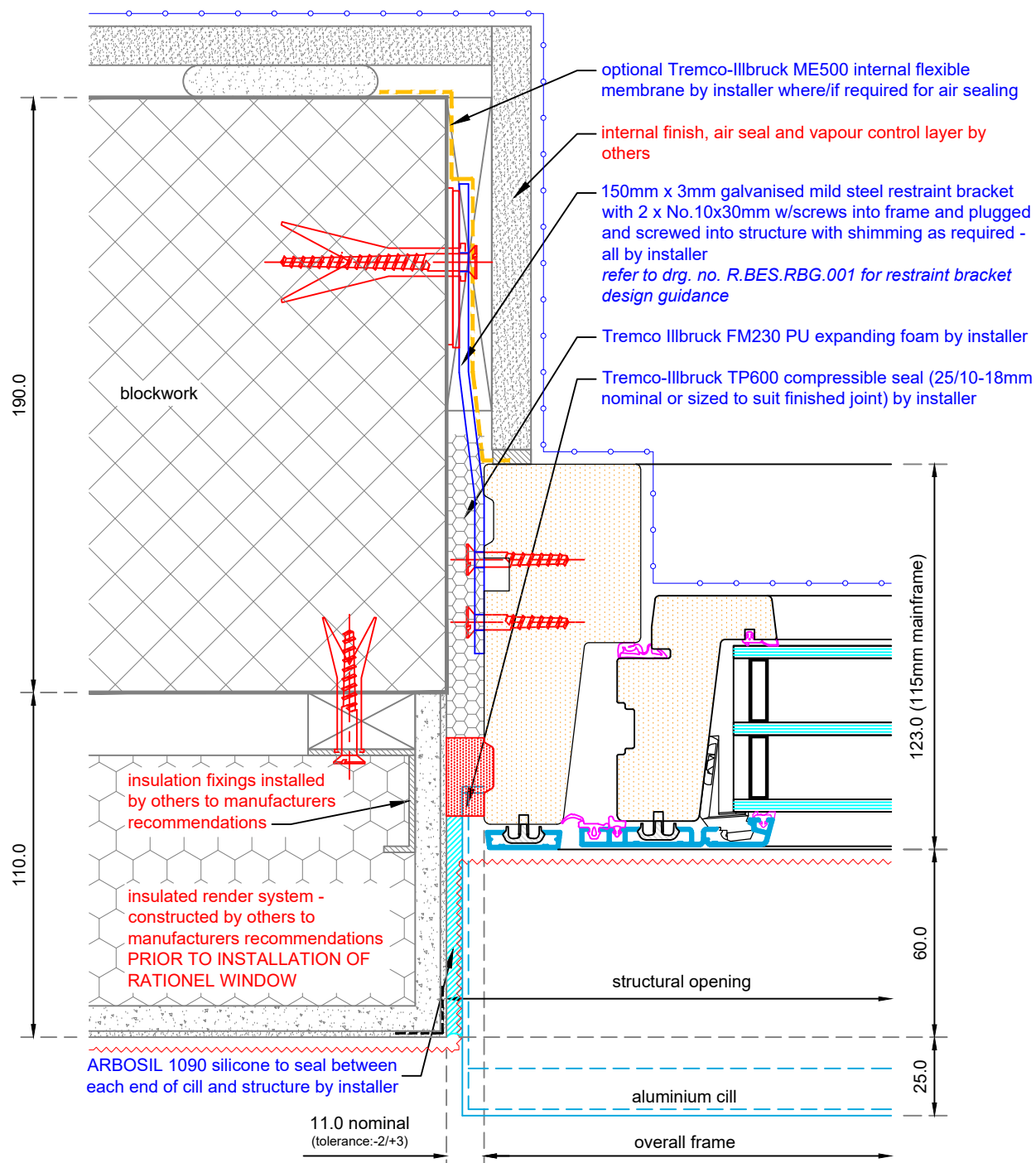

IMPORTANT NOTE: When installing Rationel windows and accessories, please ensure compliance with national building regulations and British/European standards where necessary. This drawing is for guidance only and the customer must be satisfied that the principles outlined in this drawing are effectively transposed to suit specific project requirements and site conditions.

All dimensions are in millimetres where shown. Do not scale.

NOTES:

1. External weather seal to be either Tremco-Ilbruck joint sealing tape sized to suit finished joint size or ARBOSIL 1090 silicone seal and polyethelene backing rod.
2. Fixings and brackets to be installed strictly in accordance with Rationel installation guidance.
3. Fixing grounds must be able to withstand all loads transmitted from and through the Rationel system.

~~~~~ primary weather line

—○— primary air barrier line

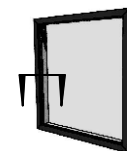

| Rev | Date | By | Description |
|-----|------|----|-------------|

Title:

Rationel AURAPLUS  
TYPICAL JAMB DETAIL  
insulated render/block masonry

Scale: 1:2 approx @ A4

Drawing no:

Date: January 2017

AURA+.W1.02.A.J.001

Drawn: Studio62

Status: approved

Revision:

**rationel**<sup>®</sup>

Rationel Windows (UK) Ltd.

7 Avonbury Business Park, Howes Lane,  
Bicester, Oxfordshire. OX26 2UA

tel: 01869 248181

fax: 01869 249693

web: www.rationel.co.uk

© Rationel Windows (UK) Ltd. This drawing must not be copied, reproduced or published in whole or in part for commercial gain without prior written permission of Rationel Windows (UK) Ltd.

\*where smaller setback is required,  
please reconsider structural support  
for the window load

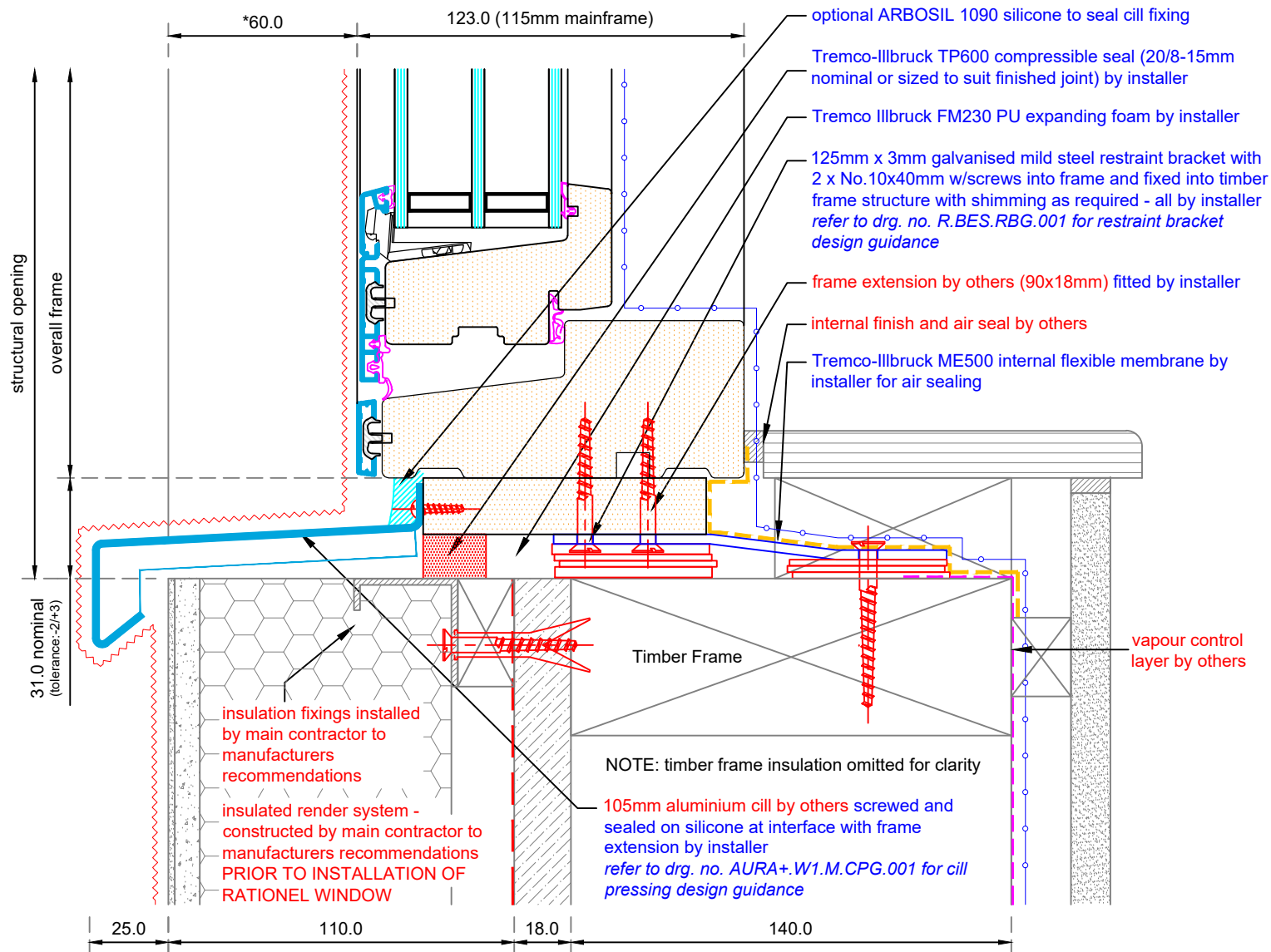

**PLEASE NOTE:**

this detail assumes there is no differential movement between the external building finish and the structural timber frame  
i.e. - external finish is fixed directly to timber frame and any required movement joints are outside of the window zone.

**IMPORTANT NOTE:** When installing Rational windows and accessories, please ensure compliance with national building regulations and British/European standards where necessary. This drawing is for guidance only and the customer must be satisfied that the principles outlined in this drawing are effectively transposed to suit specific project requirements and site conditions.

All dimensions are in millimetres where shown. Do not scale.

**NOTES:**

1. External weather seal to be either Tremco-Ilbruck joint sealing tape sized to suit finished joint size or ARBOSIL 1090 silicone seal and polyethelene backing rod.
2. Fixings and brackets to be installed strictly in accordance with Rational installation guidance.
3. Fixing grounds must be able to withstand all loads transmitted from and through the Rational system.

~~~~~ primary weather line

—○— primary air barrier line



| | | | |
|-----|------|----|-------------|
| Rev | Date | By | Description |
| | | | |
| | | | |
| | | | |
| | | | |

Title:

Rational AURAPLUS
TYPICAL CILL DETAIL
insulated render/timber frame

Scale: 1:2 approx @ A4

Drawing no:

Date: January 2017

AURA+.W1.02.B.C.001

Drawn: Studio62

Status: approved

Revision:

rational[®]

Rational Windows (UK) Ltd.
7 Avonbury Business Park, Howes Lane,
Bicester, Oxfordshire. OX26 2UA

tel: 01869 248181

fax: 01869 249693

web: www.rational.co.uk

© Rational Windows (UK) Ltd. This drawing must not be copied, reproduced or published in whole or in part for commercial gain without prior written permission of Rational Windows (UK) Ltd.

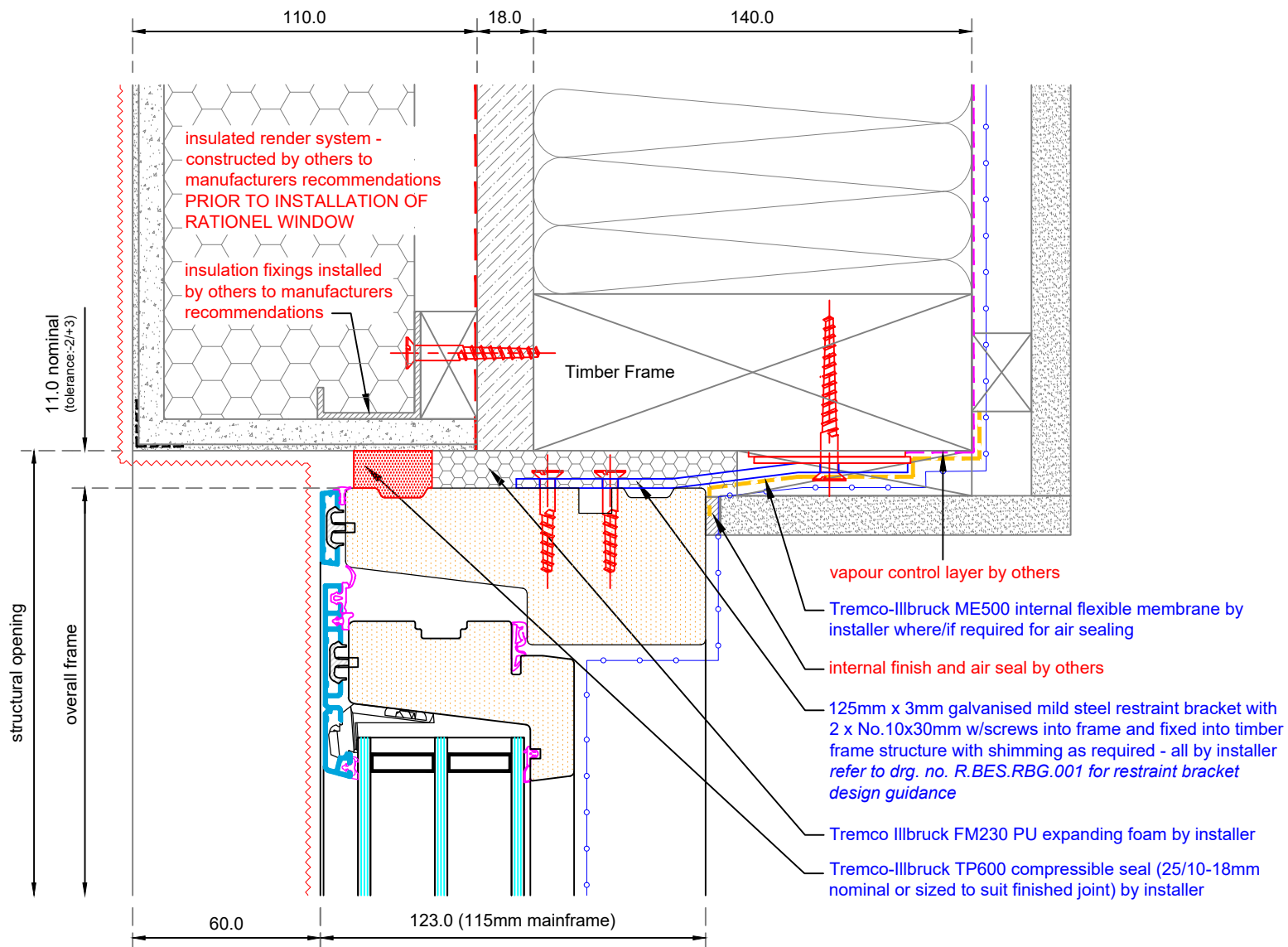

PLEASE NOTE:
this detail assumes there is no differential movement between the external building finish and the structural timber frame
i.e. - external finish is fixed directly to timber frame and any required movement joints are outside of the window zone.

IMPORTANT NOTE: When installing Rational windows and accessories, please ensure compliance with national building regulations and British/European standards where necessary. This drawing is for guidance only and the customer must be satisfied that the principles outlined in this drawing are effectively transposed to suit specific project requirements and site conditions.

All dimensions are in millimetres where shown. Do not scale.

NOTES:

1. External weather seal to be either Tremco-IIIbruck joint sealing tape sized to suit finished joint size or ARBOSIL 1090 silicone seal and polyethelene backing rod.
2. Fixings and brackets to be installed strictly in accordance with Rational installation guidance.
3. Fixing grounds must be able to withstand all loads transmitted from and through the Rational system.

~~~~~ primary weather line  
- - - primary air barrier line



| Rev | Date | By | Description |
|-----|------|----|-------------|

Title:

Rational AURAPLUS  
**TYPICAL HEAD DETAIL**  
insulated render/timber frame

Scale: 1:2 approx @ A4

Drawing no:

Date: January 2017

AURA+.W1.02.B.H.001

Drawn: Studio62

Status: approved

Revision:

**rational®**

Rational Windows (UK) Ltd.  
7 Avonbury Business Park, Howes Lane,  
Bicester, Oxfordshire. OX26 2UA

tel: 01869 248181

fax: 01869 249693

web: www.rational.co.uk

© Rational Windows (UK) Ltd. This drawing must not be copied, reproduced or published in whole or in part for commercial gain without prior written permission of Rational Windows (UK) Ltd.



\*where smaller setback is required,  
please reconsider structural support  
for the window load

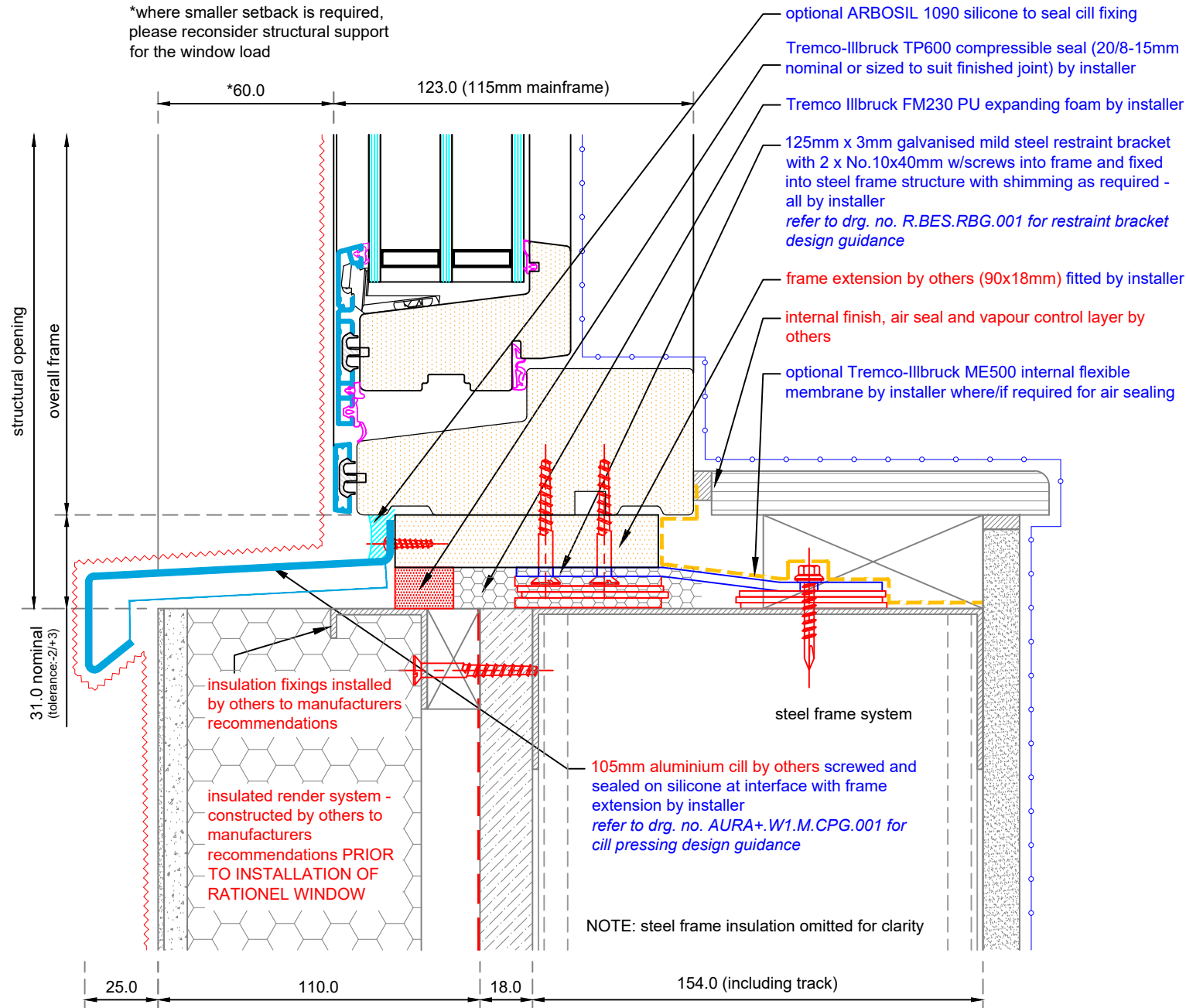

**IMPORTANT NOTE:** When installing Rational windows and accessories, please ensure compliance with national building regulations and British/European standards where necessary. This drawing is for guidance only and the customer must be satisfied that the principles outlined in this drawing are effectively transposed to suit specific project requirements and site conditions.

All dimensions are in millimetres where shown. Do not scale.

#### NOTES:

- External weather seal to be either Tremco-Ilbruck joint sealing tape sized to suit finished joint size or ARBOSIL 1090 silicone seal and polyethylene backing rod.
- Fixings and brackets to be installed strictly in accordance with Rational installation guidance.
- Fixing grounds must be able to withstand all loads transmitted from and through the Rational system.

primary weather line  
primary air barrier line



|     |      |    |             |
|-----|------|----|-------------|
| Rev | Date | By | Description |
|     |      |    |             |
|     |      |    |             |
|     |      |    |             |
|     |      |    |             |

Title:

Rational AURAPLUS  
**TYPICAL CILL DETAIL**  
insulated render/steel frame system

Scale: 1:2 approx @ A4

Drawing no:

Date: January 2017

AURA+.W1.02.C.C.001

Drawn: Studio62

Status: approved

Revision:

**rational**<sup>®</sup>

Rational Windows (UK) Ltd.  
7 Avonbury Business Park, Howes Lane,  
Bicester, Oxfordshire. OX26 2UA

tel: 01869 248181  
fax: 01869 249693  
web: www.rational.co.uk

© Rational Windows (UK) Ltd. This drawing must not be copied, reproduced or published in whole or in part for commercial gain without prior written permission of Rational Windows (UK) Ltd.







structural opening

overall frame

31.0 nominal (tolerance: -2/+3)

\*60.0

123.0 (115mm mainframe)

125mm x 3mm galvanised mild steel with 2 x No.10x40mm w/screws into structural insulated panel - all by installer refer to drg. no. R.BES.RBG.001 for design guidance

frame extension by others (90x18mm)

internal finish and air seal by others

Tremco-illbruck ME500 internal flashings installer for air sealing

vapour control layer by others

insulation fixings installed by others to manufacturers recommendations

insulated render system - constructed by others to manufacturers recommendations PRIOR TO INSTALLATION OF RATIONEL WINDOW

SIP system

105mm aluminium cill by others screwed and sealed on silicone at interface with frame extension by installer refer to drg. no. AURA+.W1.M.CPG.001 for cill pressing design guidance

25.0

110.0

150.0

A blackboard with a piece of chalk.

|                        |                                        |
|------------------------|----------------------------------------|
| Scale: 1:2 approx @ A4 | Drawing no:<br><br>AURA+.W1.02.D.C.001 |
| Date: January 2017     |                                        |
| Drawn: Studio62        | Revision:                              |
| Status: approved       |                                        |

© Rational Windows (UK) Ltd. This drawing must not be copied, reproduced or published in whole or in part for commercial gain without prior written permission of Rational Windows (UK) Ltd.

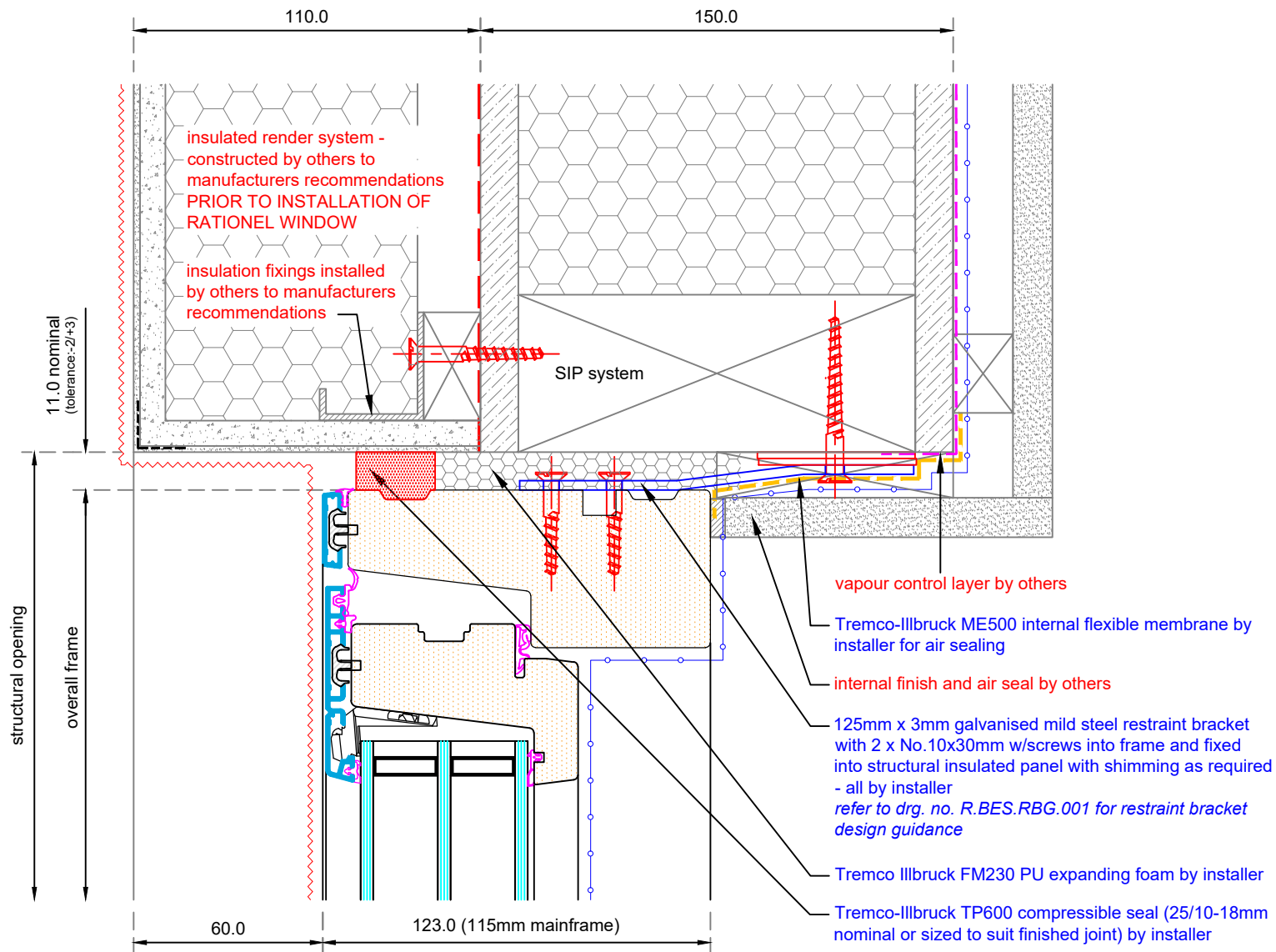

**IMPORTANT NOTE:** When installing Rationel windows and accessories, please ensure compliance with national building regulations and British/European standards where necessary. This drawing is for guidance only and the customer must be satisfied that the principles outlined in this drawing are effectively transposed to suit specific project requirements and site conditions.

All dimensions are in millimetres where shown. Do not scale.

#### NOTES:

1. External weather seal to be either Tremco-IIIbruck joint sealing tape sized to suit finished joint size or ARBOSIL 1090 silicone seal and polyethelene backing rod.
2. Fixings and brackets to be installed strictly in accordance with Rationel installation guidance.
3. Fixing grounds must be able to withstand all loads transmitted from and through the Rationel system.



|     |      |    |             |
|-----|------|----|-------------|
| Rev | Date | By | Description |
|     |      |    |             |
|     |      |    |             |
|     |      |    |             |
|     |      |    |             |
|     |      |    |             |

Title:

Rationel AURAPLUS  
**TYPICAL HEAD DETAIL**  
insulated render/structural insulated panel

|                        |                     |
|------------------------|---------------------|
| Scale: 1:2 approx @ A4 | Drawing no:         |
| Date: January 2017     | AURA+.W1.02.D.H.001 |
| Drawn: Studio62        | Revision:           |
| Status: approved       |                     |

**rationel**<sup>®</sup>

Rationel Windows (UK) Ltd.  
7 Avonbury Business Park, Howes Lane,  
Bicester, Oxfordshire. OX26 2UA

tel: 01869 248181  
fax: 01869 249693  
web: www.rationel.co.uk

© Rationel Windows (UK) Ltd. This drawing must not be copied, reproduced or published in whole or in part for commercial gain without prior written permission of Rationel Windows (UK) Ltd.





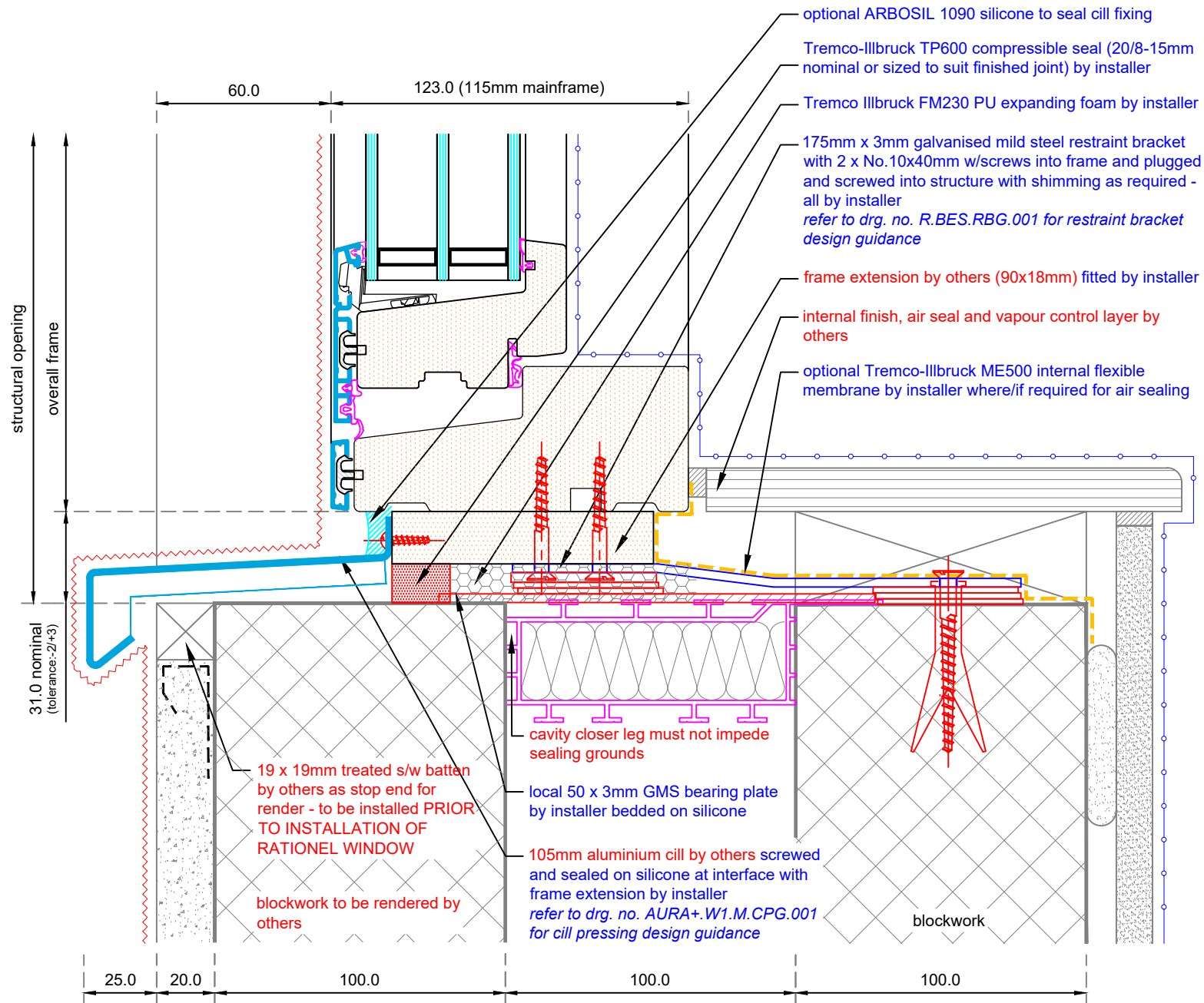

**IMPORTANT NOTE:** When installing Rational windows and accessories, please ensure compliance with national building regulations and British/European standards where necessary. This drawing is for guidance only and the customer must be satisfied that the principles outlined in this drawing are effectively transposed to suit specific project requirements and site conditions.

All dimensions are in millimetres where shown. Do not scale.

#### NOTES:

1. External weather seal to be either Tremco-Ilbruck joint sealing tape sized to suit finished joint size or ARBOSIL 1090 silicone seal and polyethelene backing rod.
2. Fixings and brackets to be installed strictly in accordance with Rational installation guidance.
3. Fixing grounds must be able to withstand all loads transmitted from and through the Rational system.

primary weather line

primary air barrier line



|     |      |    |             |
|-----|------|----|-------------|
| Rev | Date | By | Description |
|     |      |    |             |
|     |      |    |             |
|     |      |    |             |
|     |      |    |             |

Title:

Rational AURAPLUS  
**TYPICAL CILL DETAIL**  
rendered block/block masonry

Scale: 1:2 approx @ A4

Drawing no:

Date: January 2017

AURA+.W1.03.A.C.001

Drawn: Studio62

Status: approved

Revision:

**rational**<sup>®</sup>

Rational Windows (UK) Ltd.  
7 Avonbury Business Park, Howes Lane,  
Bicester, Oxfordshire. OX26 2UA

tel: 01869 248181

fax: 01869 249693

web: www.rational.co.uk

© Rational Windows (UK) Ltd. This drawing must not be copied, reproduced or published in whole or in part for commercial gain without prior written permission of Rational Windows (UK) Ltd.









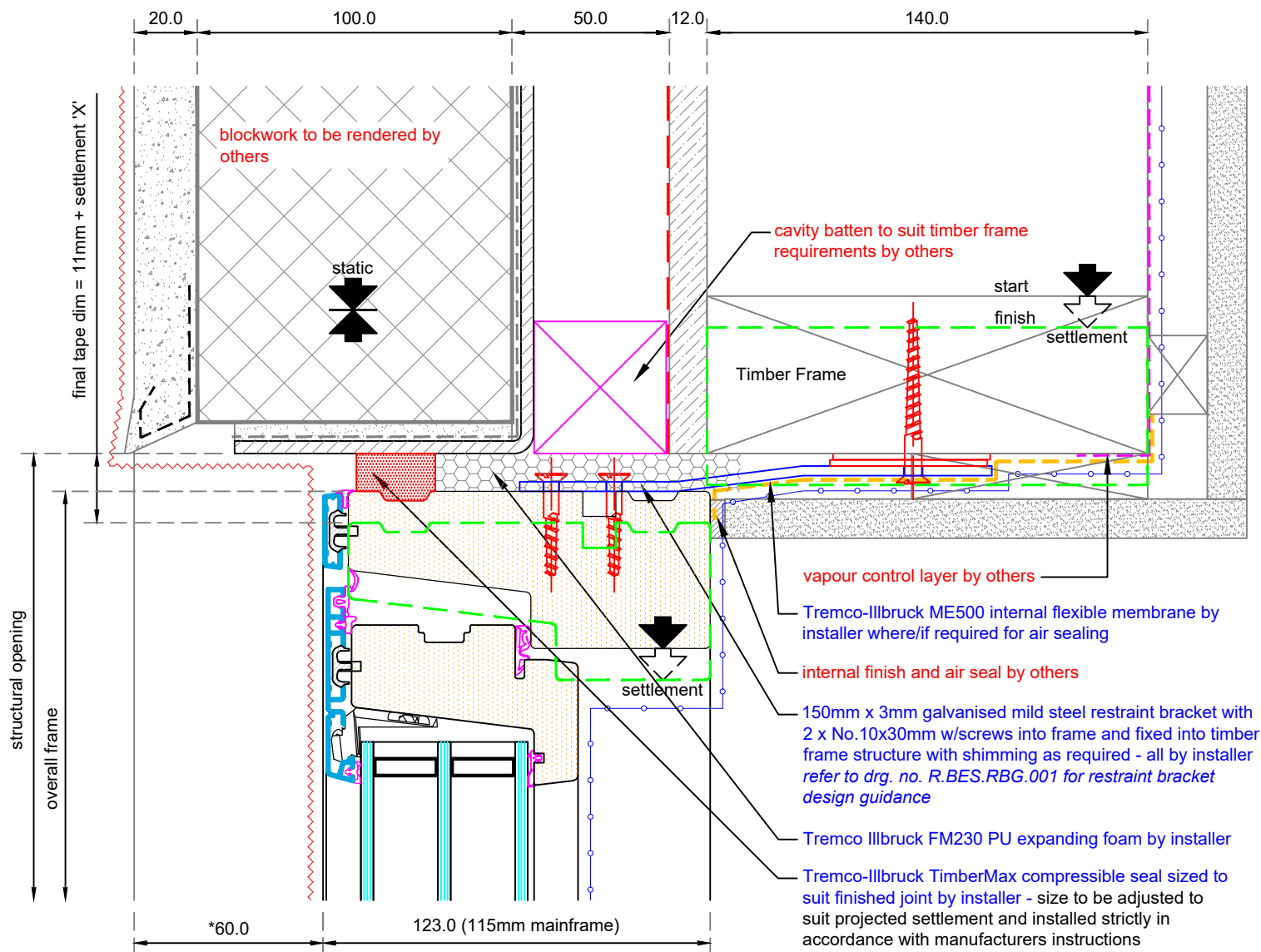

| settlement 'X' per storey (up to 5 stories) |                                      |                                      |
|---------------------------------------------|--------------------------------------|--------------------------------------|
| location                                    | using solid timber joist floors (mm) | using engineered i-joist floors (mm) |
| ground storey                               | 3                                    | 3                                    |
| first storey                                | 12                                   | 9                                    |
| second storey                               | 21                                   | 15                                   |
| third storey                                | 30                                   | 21                                   |
| fourth storey                               | 39                                   | 27                                   |
| fifth storey                                | 48                                   | 33                                   |

Source: LABC warranty technical manual v.7

#### NOTES:

- \*window setback dimension to be adjusted to ensure that required Tremco Ilbruck tape width does not encroach over timber frame structure - refer to manufacturers literature for tape size in relation to storey settlement
- timber frame insulation omitted for clarity
- window fixings must be to timber frame only, NOT to external structure/finish which remains static during settlement
- data in adjacent table is to be used in absence of project specific calculations and assumes use of timber with moisture content of less than 20% bearing on concrete ground floor

**IMPORTANT NOTE:** When installing Rational windows and accessories, please ensure compliance with national building regulations and British/European standards where necessary. This drawing is for guidance only and the customer must be satisfied that the principles outlined in this drawing are effectively transposed to suit specific project requirements and site conditions.

All dimensions are in millimetres where shown. Do not scale.

#### NOTES:

1. External weather seal to be either Tremco-Ilbruck joint sealing tape sized to suit finished joint size or ARBOSIL 1090 silicone seal and polyethelene backing rod.
2. Fixings and brackets to be installed strictly in accordance with Rational installation guidance.
3. Fixing grounds must be able to withstand all loads transmitted from and through the Rational system.

~~~~~ primary weather line  
 --- primary air barrier line



| | | | |
|-----|------|----|-------------|
| Rev | Date | By | Description |
| | | | |
| | | | |
| | | | |
| | | | |

Title:

Rational AURAPLUS
TYPICAL HEAD DETAIL
 rendered blockwork/timber frame

Scale: 1:2 approx @ A4

Drawing no:

Date: January 2017

AURA+.W1.03.B.H.001

Drawn: Studio62

Status: approved

Revision:

rational[®]

Rational Windows (UK) Ltd.
 7 Avonbury Business Park, Howes Lane,
 Bicester, Oxfordshire. OX26 2UA

tel: 01869 248181
 fax: 01869 249693
 web: www.rational.co.uk

© Rational Windows (UK) Ltd. This drawing must not be copied, reproduced or published in whole or in part for commercial gain without prior written permission of Rational Windows (UK) Ltd.

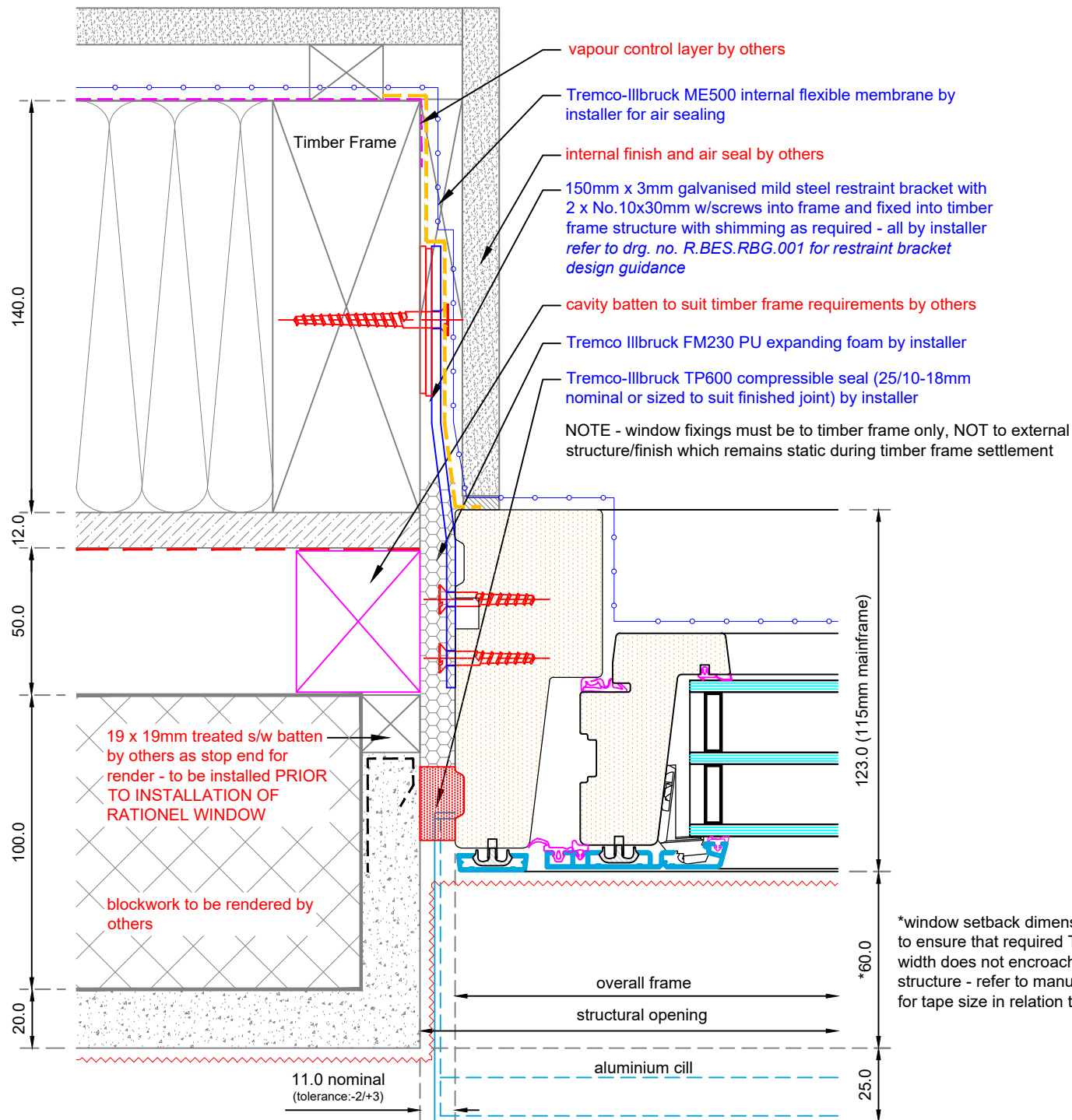

IMPORTANT NOTE: When installing Rationel windows and accessories, please ensure compliance with national building regulations and British/European standards where necessary. This drawing is for guidance only and the customer must be satisfied that the principles outlined in this drawing are effectively transposed to suit specific project requirements and site conditions.

All dimensions are in millimetres where shown. Do not scale.

NOTES:

1. External weather seal to be either Tremco-Ilbruck joint sealing tape sized to suit finished joint size or ARBOSIL 1090 silicone seal and polyethelene backing rod.
2. Fixings and brackets to be installed strictly in accordance with Rationel installation guidance.
3. Fixing grounds must be able to withstand all loads transmitted from and through the Rationel system.

~~~~~ primary weather line  
 ---o--- primary air barrier line

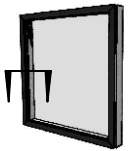

|     |      |    |             |
|-----|------|----|-------------|
| Rev | Date | By | Description |
|     |      |    |             |
|     |      |    |             |
|     |      |    |             |
|     |      |    |             |

Title:

**Rationel AURPLUS**  
**TYPICAL JAMB DETAIL**  
 rendered blockwork/timber frame

Scale: 1:2 approx @ A4

Drawing no:

Date: January 2017

AURA+.W1.03.B.J.001

Drawn: Studio62

Status: approved

Revision:

**rationel**<sup>®</sup>

Rationel Windows (UK) Ltd.  
 7 Avonbury Business Park, Howes Lane,  
 Bicester, Oxfordshire. OX26 2UA

tel: 01869 248181  
 fax: 01869 249693  
 web: www.rationel.co.uk

© Rationel Windows (UK) Ltd. This drawing must not be copied, reproduced or published in whole or in part for commercial gain without prior written permission of Rationel Windows (UK) Ltd.

\*window setback dimension to be adjusted to ensure that required Tremco Ilbruck tape width does not encroach over timber frame structure - refer to manufacturers literature for tape size in relation to storey settlement

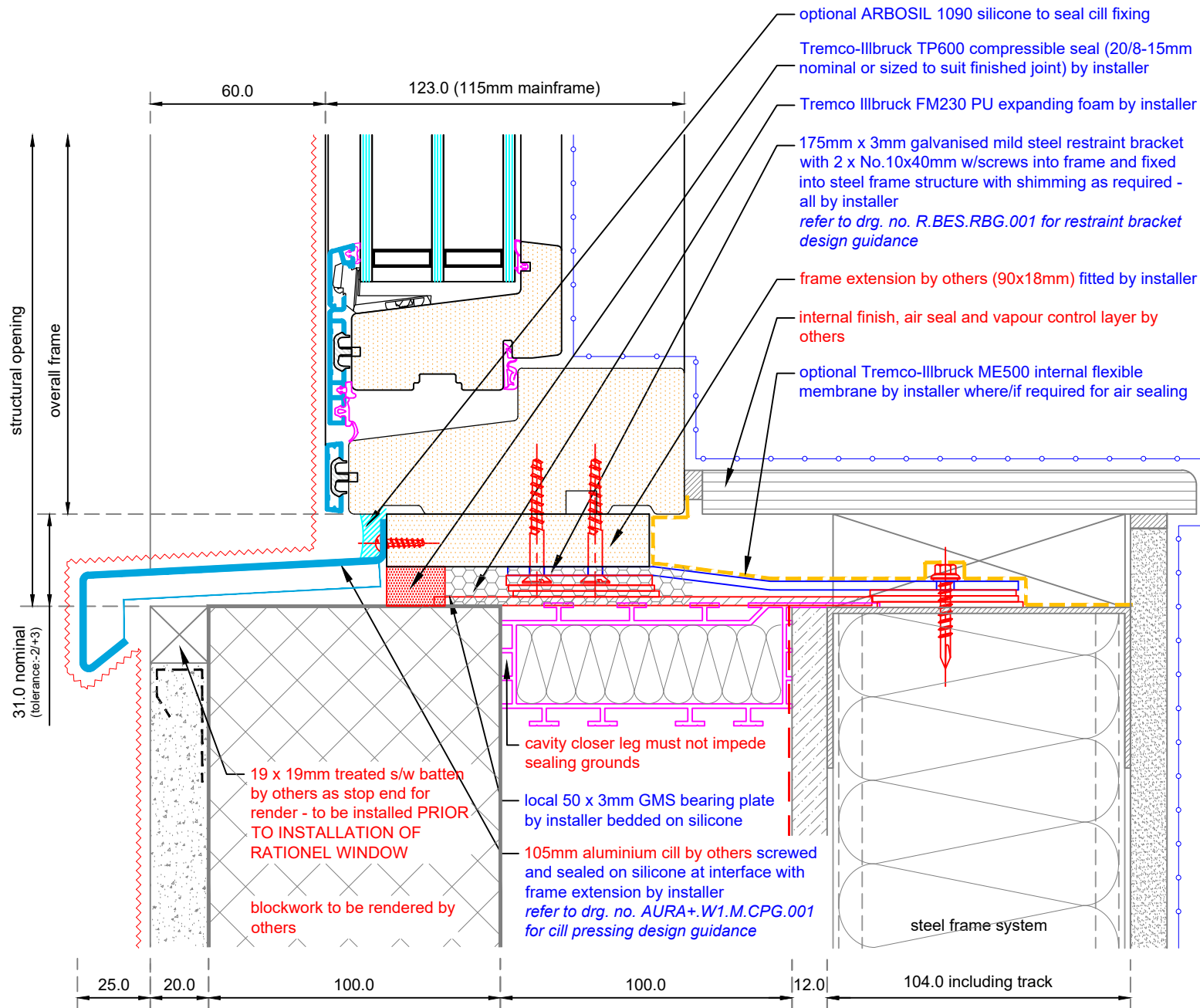

**IMPORTANT NOTE:** When installing Rational windows and accessories, please ensure compliance with national building regulations and British/European standards where necessary. This drawing is for guidance only and the customer must be satisfied that the principles outlined in this drawing are effectively transposed to suit specific project requirements and site conditions.

All dimensions are in millimetres where shown. Do not scale.

#### NOTES:

1. External weather seal to be either Tremco-IIIbruck joint sealing tape sized to suit finished joint size or ARBOSIL 1090 silicone seal and polyethelene backing rod.
2. Fixings and brackets to be installed strictly in accordance with Rational installation guidance.
3. Fixing grounds must be able to withstand all loads transmitted from and through the Rational system.

primary weather line

primary air barrier line



|     |      |    |             |
|-----|------|----|-------------|
| Rev | Date | By | Description |
|     |      |    |             |
|     |      |    |             |
|     |      |    |             |
|     |      |    |             |

Title:

Rational AURAPLUS  
**TYPICAL CILL DETAIL**  
rendered blockwork/steel frame system

Scale: 1:2 approx @ A4

Drawing no:

Date: January 2017

AURA+.W1.03.C.C.001

Drawn: Studio62

Status: approved

Revision:

**rational**<sup>®</sup>

Rational Windows (UK) Ltd.  
7 Avonbury Business Park, Howes Lane,  
Bicester, Oxfordshire. OX26 2UA

tel: 01869 248181  
fax: 01869 249693  
web: www.rational.co.uk

© Rational Windows (UK) Ltd. This drawing must not be copied, reproduced or published in whole or in part for commercial gain without prior written permission of Rational Windows (UK) Ltd.





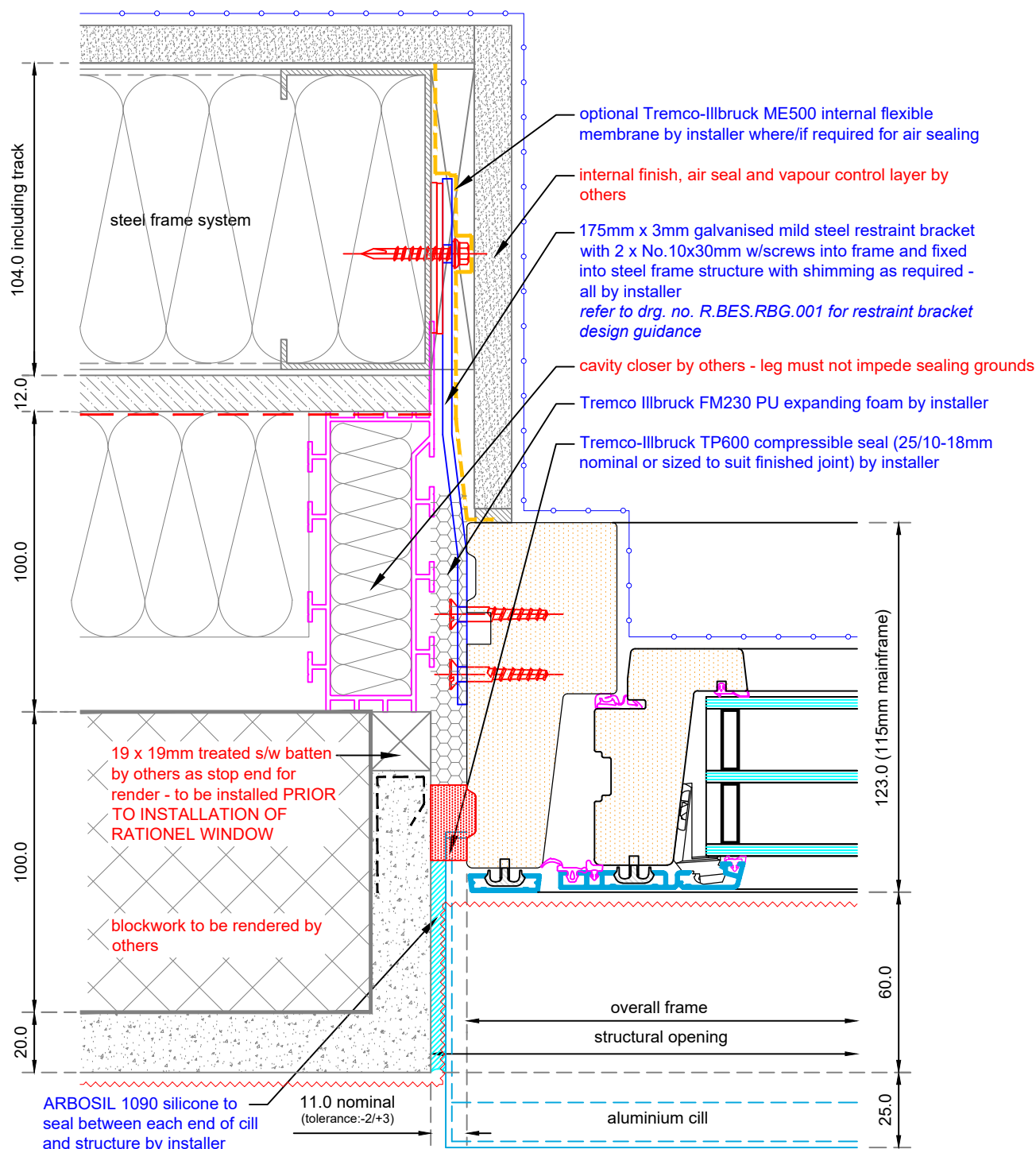

**IMPORTANT NOTE:** When installing Rationel windows and accessories, please ensure compliance with national building regulations and British/European standards where necessary. This drawing is for guidance only and the customer must be satisfied that the principles outlined in this drawing are effectively transposed to suit specific project requirements and site conditions.

All dimensions are in millimetres where shown. Do not scale.

#### NOTES:

1. External weather seal to be either Tremco-Ilbruck joint sealing tape sized to suit finished joint size or ARBOSIL 1090 silicone seal and polyethelene backing rod.
2. Fixings and brackets to be installed strictly in accordance with Rationel installation guidance.
3. Fixing grounds must be able to withstand all loads transmitted from and through the Rationel system.

~~~~~ primary weather line

—○— primary air barrier line

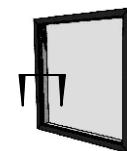

| | | | |
|-----|------|----|-------------|
| Rev | Date | By | Description |
| | | | |
| | | | |
| | | | |
| | | | |

Title:

Rationel AURAPLUS
TYPICAL JAMB DETAIL
rendered blockwork/steel frame system

Scale: 1:2 approx @ A4

Drawing no:

Date: January 2017

AURA+.W1.03.C.J.001

Drawn: Studio62

Status: approved

Revision:

rationel[®]

Rationel Windows (UK) Ltd.
7 Avonbury Business Park, Howes Lane,
Bicester, Oxfordshire. OX26 2UA

tel: 01869 248181

fax: 01869 249693

web: www.rationel.co.uk

© Rationel Windows (UK) Ltd. This drawing must not be copied, reproduced or published in whole or in part for commercial gain without prior written permission of Rationel Windows (UK) Ltd.

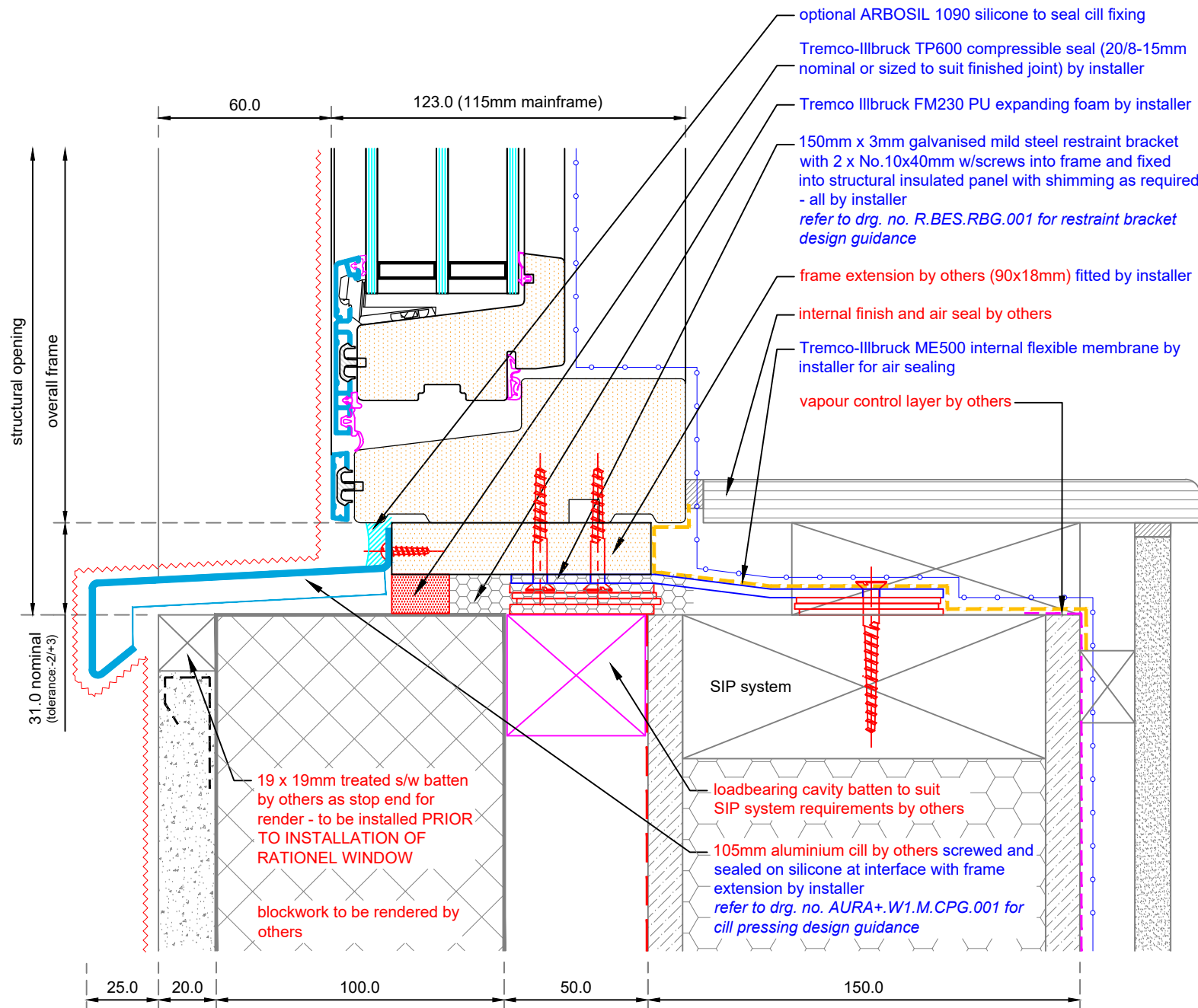

IMPORTANT NOTE: When installing Rational windows and accessories, please ensure compliance with national building regulations and British/European standards where necessary. This drawing is for guidance only and the customer must be satisfied that the principles outlined in this drawing are effectively transposed to suit specific project requirements and site conditions.

All dimensions are in millimetres where shown. Do not scale.

NOTES:

1. External weather seal to be either Tremco-Ilbruck joint sealing tape sized to suit finished joint size or ARBOSIL 1090 silicone seal and polyethelene backing rod.
2. Fixings and brackets to be installed strictly in accordance with Rational installation guidance.
3. Fixing grounds must be able to withstand all loads transmitted from and through the Rational system.

~~~~~ primary weather line  
- - - - - primary air barrier line



| Rev | Date | By | Description |
|-----|------|----|-------------|
|     |      |    |             |
|     |      |    |             |
|     |      |    |             |
|     |      |    |             |
|     |      |    |             |
|     |      |    |             |
|     |      |    |             |
|     |      |    |             |
|     |      |    |             |
|     |      |    |             |

Title:

Rational AURAPLUS  
**TYPICAL CILL DETAIL**  
rendered blockwork/structural insulated panel

Scale: 1:2 approx @ A4

Drawing no:

Date: January 2017

AURA+.W1.03.D.C.001

Drawn: Studio62

Status: approved

Revision:

**rational**<sup>®</sup>

Rational Windows (UK) Ltd.  
7 Avonbury Business Park, Howes Lane,  
Bicester, Oxfordshire. OX26 2UA

tel: 01869 248181  
fax: 01869 249693  
web: www.rational.co.uk

© Rational Windows (UK) Ltd. This drawing must not be copied, reproduced or published in whole or in part for commercial gain without prior written permission of Rational Windows (UK) Ltd.

















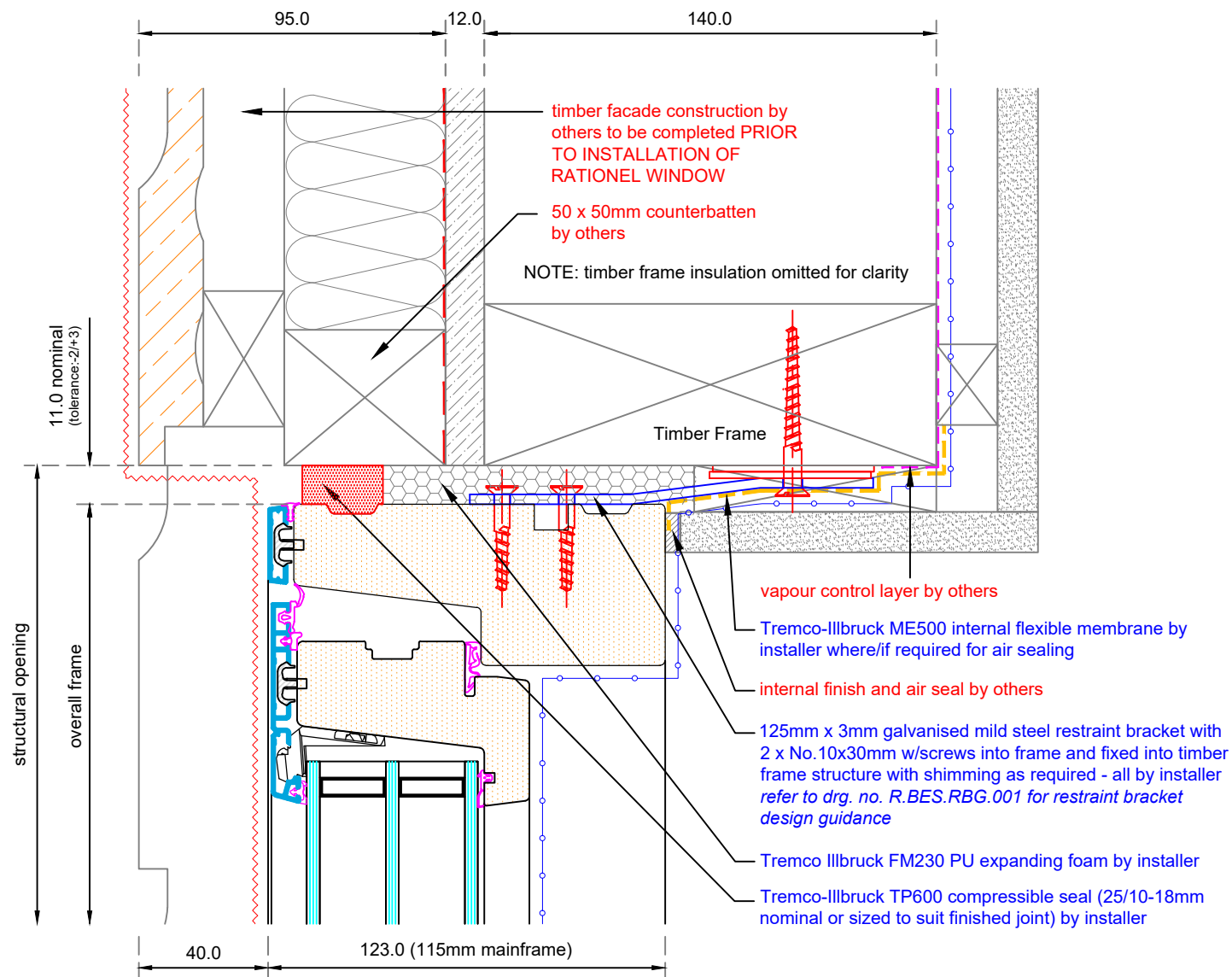

**PLEASE NOTE:**  
this detail assumes there is no differential movement between the external building finish and the structural timber frame  
i.e. - external finish is fixed directly to timber frame and any required movement joints are outside of the window zone.

**IMPORTANT NOTE:** When installing Rationel windows and accessories, please ensure compliance with national building regulations and British/European standards where necessary. This drawing is for guidance only and the customer must be satisfied that the principles outlined in this drawing are effectively transposed to suit specific project requirements and site conditions.

All dimensions are in millimetres where shown. Do not scale.

#### NOTES:

1. External weather seal to be either Tremco-IIIbruck joint sealing tape sized to suit finished joint size or ARBOSIL 1090 silicone seal and polyethylene backing rod.
2. Fixings and brackets to be installed strictly in accordance with Rationel installation guidance.
3. Fixing grounds must be able to withstand all loads transmitted from and through the Rationel system.



|     |      |    |             |
|-----|------|----|-------------|
| Rev | Date | By | Description |
|     |      |    |             |
|     |      |    |             |
|     |      |    |             |
|     |      |    |             |
|     |      |    |             |

Title:

Rationel AURAPLUS  
**TYPICAL HEAD DETAIL**  
timber/timber frame

Scale: 1:2 approx @ A4

Drawing no:

Date: January 2017

AURA+.W1.04.B.H.001

Drawn: Studio62

Status: approved

Revision:

**rationel**<sup>®</sup>

Rationel Windows (UK) Ltd.  
7 Avonbury Business Park, Howes Lane,  
Bicester, Oxfordshire. OX26 2UA

tel: 01869 248181

fax: 01869 249693

web: www.rationel.co.uk

© Rationel Windows (UK) Ltd. This drawing must not be copied, reproduced or published in whole or in part for commercial gain without prior written permission of Rationel Windows (UK) Ltd.

**IMPORTANT NOTE:** When installing Rational windows and accessories, please ensure compliance with national building regulations and British/European standards where necessary. This drawing is for guidance only and the customer must be satisfied that the principles outlined in this drawing are effectively transposed to suit specific project requirements and site conditions.

All dimensions are in millimetres where shown. Do not scale.

#### NOTES:

1. External weather seal to be either Tremco-Ilbruck joint sealing tape sized to suit finished joint size or ARBOSIL 1090 silicone seal and polyethelene backing rod.
2. Fixings and brackets to be installed strictly in accordance with Rational installation guidance.
3. Fixing grounds must be able to withstand all loads transmitted from and through the Rational system.

~~~~~ primary weather line

—○— primary air barrier line

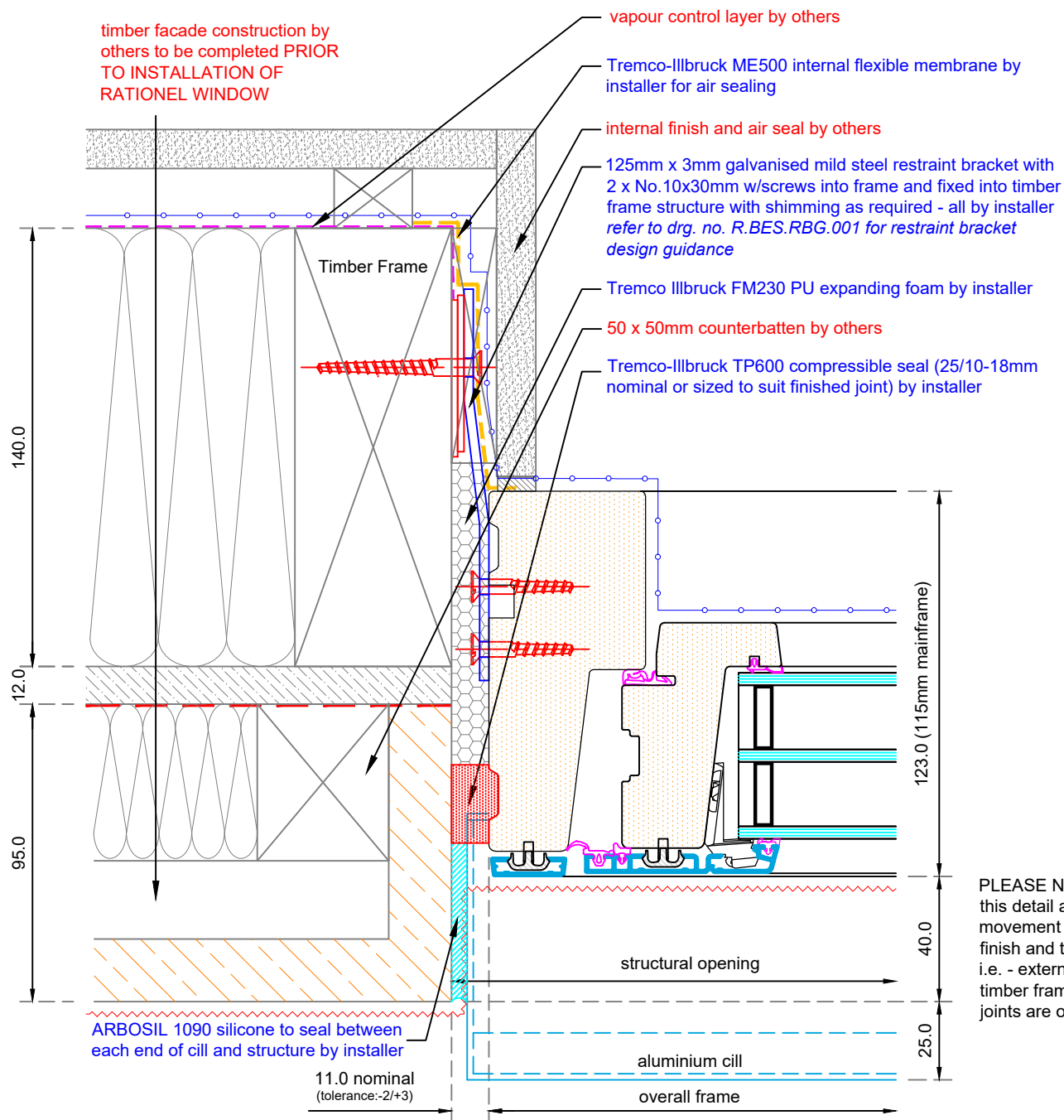

PLEASE NOTE:
this detail assumes there is no differential movement between the external building finish and the structural timber frame i.e. - external finish is fixed directly to timber frame and any required movement joints are outside of the window zone.

| Rev | Date | By | Description |
|-----|------|----|-------------|

Title:

Rational AURAPLUS
TYPICAL JAMB DETAIL
timber/timber frame

Scale: 1:2 approx @ A4

Drawing no:

Date: January 2017

AURA+.W1.04.B.J.001

Drawn: Studio62

Status: approved

Revision:

rational[®]

Rational Windows (UK) Ltd.
7 Avonbury Business Park, Howes Lane,
Bicester, Oxfordshire. OX26 2UA

tel: 01869 248181

fax: 01869 249693

web: www.rational.co.uk

© Rational Windows (UK) Ltd. This drawing must not be copied, reproduced or published in whole or in part for commercial gain without prior written permission of Rational Windows (UK) Ltd.

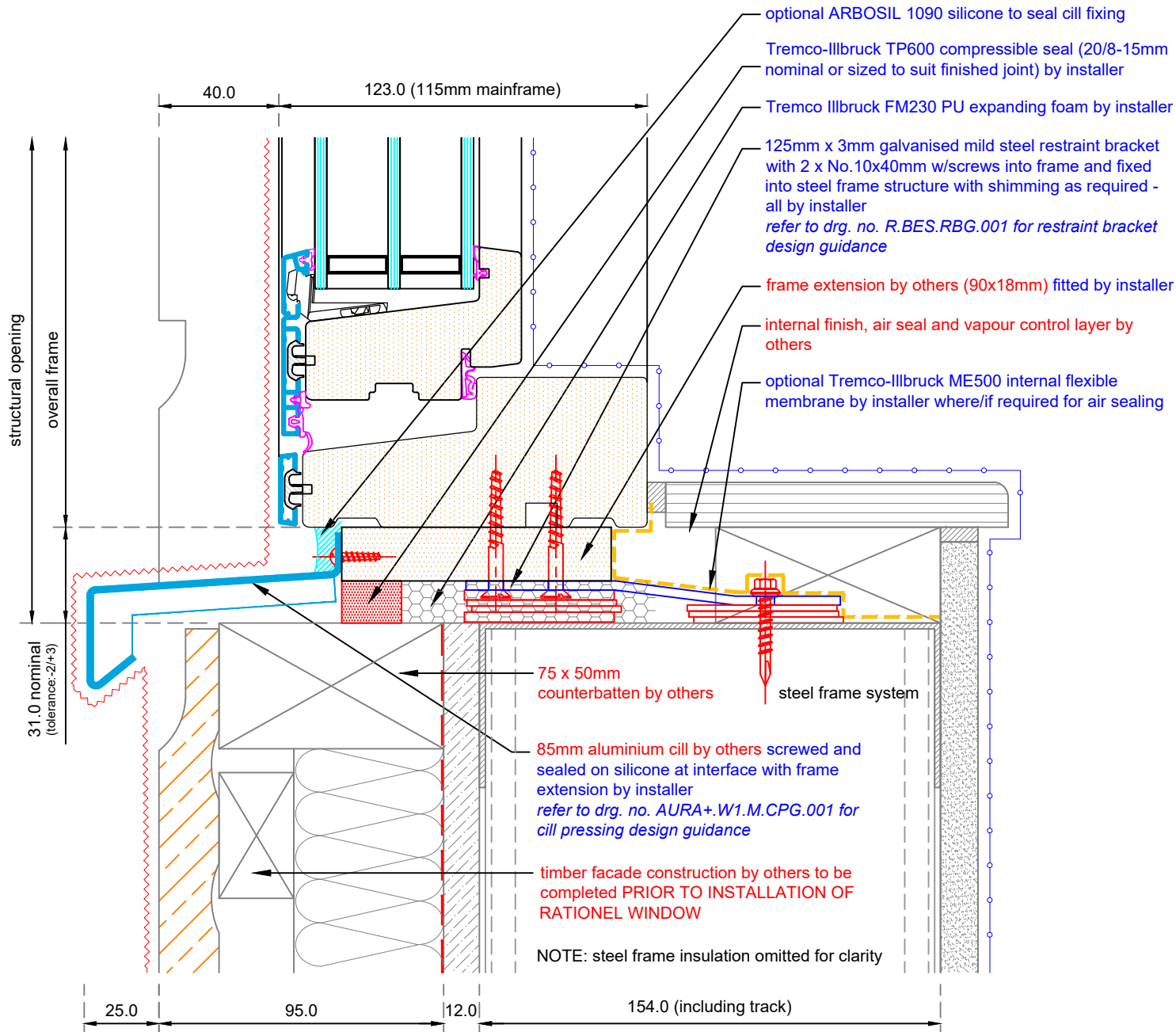

IMPORTANT NOTE: When installing Rationel windows and accessories, please ensure compliance with national building regulations and British/European standards where necessary. This drawing is for guidance only and the customer must be satisfied that the principles outlined in this drawing are effectively transposed to suit specific project requirements and site conditions.

All dimensions are in millimetres where shown. Do not scale.

NOTES:

1. External weather seal to be either Tremco-Ilbruck joint sealing tape sized to suit finished joint size or ARBOSIL 1090 silicone seal and polyethelene backing rod.
2. Fixings and brackets to be installed strictly in accordance with Rationel installation guidance.
3. Fixing grounds must be able to withstand all loads transmitted from and through the Rationel system.

~~~~~ primary weather line  
- - - - - primary air barrier line



|     |      |    |             |
|-----|------|----|-------------|
| Rev | Date | By | Description |
|     |      |    |             |
|     |      |    |             |
|     |      |    |             |
|     |      |    |             |

Title:

Rationel AURAPLUS  
**TYPICAL CILL DETAIL**  
timber/steel frame system

Scale: 1:2 approx @ A4

Drawing no:

Date: January 2017

AURA+.W1.04.C.C.001

Drawn: Studio62

Status: approved

Revision:

**rationel**<sup>®</sup>

Rationel Windows (UK) Ltd.  
7 Avonbury Business Park, Howes Lane,  
Bicester, Oxfordshire. OX26 2UA

tel: 01869 248181  
fax: 01869 249693  
web: www.rationel.co.uk

© Rationel Windows (UK) Ltd. This drawing must not be copied, reproduced or published in whole or in part for commercial gain without prior written permission of Rationel Windows (UK) Ltd.

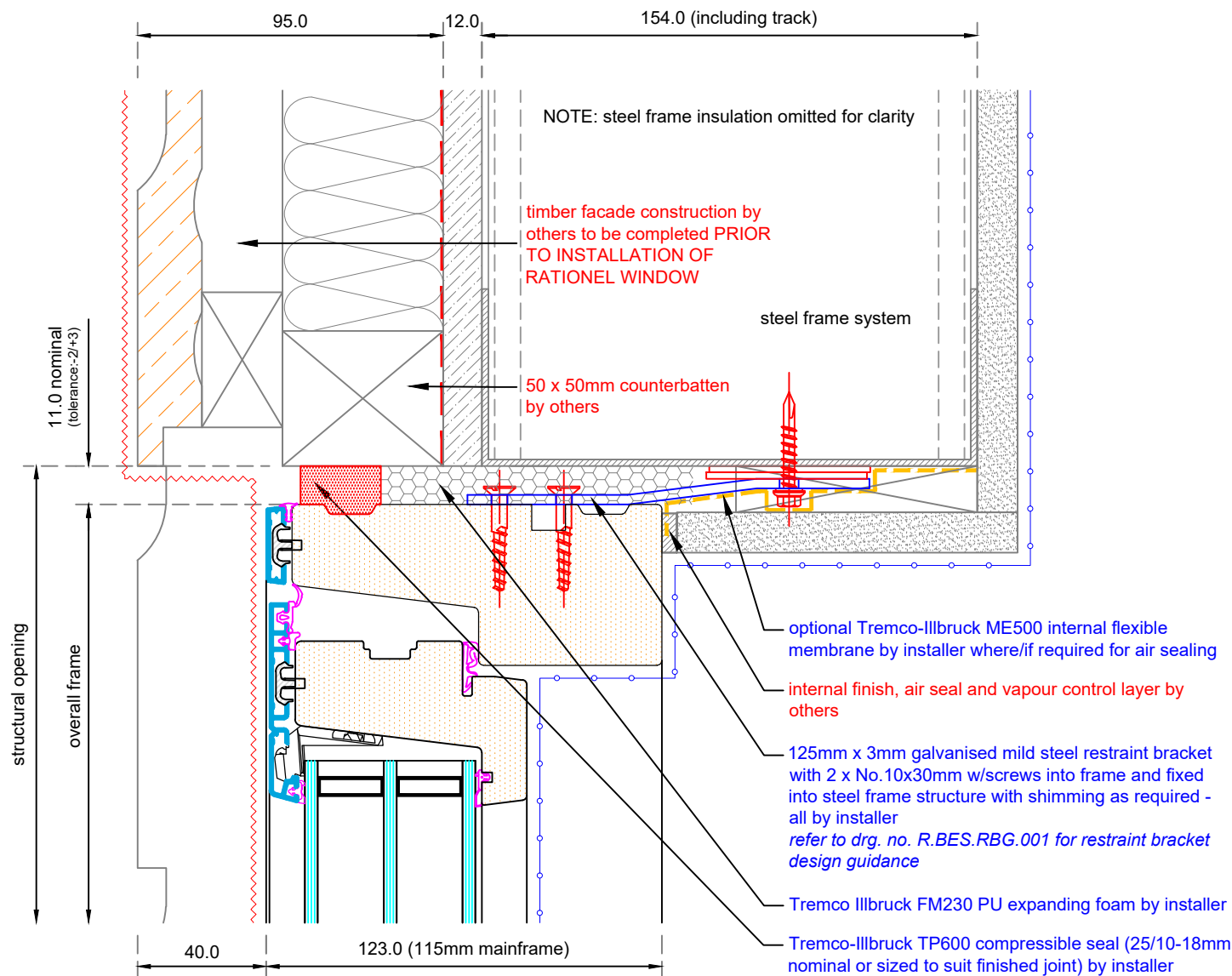

**IMPORTANT NOTE:** When installing Rational windows and accessories, please ensure compliance with national building regulations and British/European standards where necessary. This drawing is for guidance only and the customer must be satisfied that the principles outlined in this drawing are effectively transposed to suit specific project requirements and site conditions.

All dimensions are in millimetres where shown. Do not scale.

#### NOTES:

1. External weather seal to be either Tremco-Ilbruck joint sealing tape sized to suit finished joint size or ARBOSIL 1090 silicone seal and polyethylene backing rod.
2. Fixings and brackets to be installed strictly in accordance with Rational installation guidance.
3. Fixing grounds must be able to withstand all loads transmitted from and through the Rational system.

~~~~~ primary weather line

—○— primary air barrier line



| Rev | Date | By | Description |
|-----|------|----|-------------|

Title:

Rational AURAPLUS
TYPICAL HEAD DETAIL
timber/steel frame system

Scale: 1:2 approx @ A4

Drawing no:

Date: January 2017

AURA+.W1.04.C.H.001

Drawn: Studio62

Status: approved

Revision:

rational[®]

Rational Windows (UK) Ltd.
7 Avonbury Business Park, Howes Lane,
Bicester, Oxfordshire. OX26 2UA

tel: 01869 248181

fax: 01869 249693

web: www.rational.co.uk

© Rational Windows (UK) Ltd. This drawing must not be copied, reproduced or published in whole or in part for commercial gain without prior written permission of Rational Windows (UK) Ltd.

timber facade construction by others to be completed PRIOR TO INSTALLATION OF RATIONEL WINDOW

steel frame system

optional Tremco-illbruck ME500 internal flexible membrane by installer where/if required for air sealing

internal finish, air seal and vapour control layer by others

125mm x 3mm galvanised mild steel restraint bracket with 2 x No.10x30mm w/screws into frame and fixed into steel frame structure with shimming as required - all by installer
refer to drg. no. R.BES.RBG.001 for restraint bracket design guidance

Tremco Illbruck FM230 PU expanding foam by installer

50 x 50mm counterbatten by others

Tremco-illbruck TP600 compressible seal (25/10-18mm nominal or sized to suit finished joint) by installer

154.0 (including track)

12.0

95.0

123.0 (115mm mainframe)

40.0

25.0

structural opening

aluminium cill

ARBOSIL 1090 silicone to seal between each end of cill and structure by installer

11.0 nominal (tolerance:-2/+3)

overall frame

Revision:

© Rational Windows (UK) Ltd. This drawing must not be copied, reproduced or published in whole or in part for commercial gain without prior written permission of Rational Windows (UK) Ltd.

